

SE1

NOV. 82

NOVEMBER 82 15p MONTHLY NUMBER 10

TENANCY AGREEMENT

A new tenancy agreement came into force for all Southwark Council tenants on 1st November. It is the first time that this agreement, which is binding on both the council and the tenant, has actually said what the council will actually do.

'SE1' spoke to Alan Crane, who was a tenants representative on the working party which put the agreement together. His first reaction to our question was that the agreement is 'bloody marvellous'. He reckons that the tenants got 90% of what they were looking for, and that it is a very good deal.

It has taken a couple of years for the working party to come up with the goods, but things were speeded up and made much easier when the new Labour administration came in during May. Alan represented Dulwich District Tenants Committee on it, and chaired it since May. However, he does work in SE1! The group is continuing to meet to draw up a tenants handbook, which will explain the somewhat complicated and legalistic agreement, and spell out what it means to tenants on a day to day basis.

Alan pointed out the following main points:

- * arbitration scheme in the case of an argument between council and tenant, which means that no longer will the council have absolute power, having in the past been prosecutor, jury and judge.

- * the repair system is down in black and white, and is a right of every tenant. Alan would have liked the amount of time allowed for these to be halved, but as he says 'there had to be a compromise on what is practical and affordable'. Higher speed of repairs would almost certainly have meant the need to charge higher rents to cover the extra cost.

- * there is the right for a tenant to get outside contractors to do the work if the council fails to fulfil its obligations and/or get compensation for any such failure in doing repairs.

- * the tenant can now make an appointment for council workmen to call, and can be compensated for any loss of earnings if the workmen don't turn up. But equally, if the tenant fails to keep the appointment, they can be charged £30 to compensate the council.

- * tenants are allowed access to see the council's files on themselves and their dwelling, excluding certain defined items.

- * the need to try to keep families and communities together is recognised in that a tenancy may now be passed on from father to son to grandson (or mother, daughter, granddaughter etc). Also the council has to re-house the displaced party of a 'couple' if the relationship breaks up.

All Southwark tenants should by now have got a copy of the new tenancy agreement (in a brown cover). If you haven't got yours, contact the Housing Department.

inside!

PAVEMENT PERIL: PAGE 3

SPORT OR HOUSING: YOUR CHANCE TO CHOOSE: PAGE 4

NEW COMMUNITY CENTRE IN BERNMONDSEY? PAGE 5

HEALTH WORKERS: PAGE 6 & 7

A CLOWN, A CONVICT CHAINED TO HIS GUARD, THE TIN MAN AND A CINDY DOLL ALL MADE THEIR APPEARANCES IN WATERLOO ONE SUNNY SATURDAY IN OCTOBER. SEE BACK PAGE FOR STORY.....



SOCCER STAR IN SE1

Millwall star Andy Massie ran a training session for 25 local children on Hatfields Open Space during the half-term holiday. The event was jointly organised by Colombo St. Sports Centre and Action Sport.

Boys and girls, aged between 7 and 11, went through a tough programme of tackling, dribbling, passing and shooting, as well as sprints, press ups, and other fitness exercises. Action Sport workers Yvonne Baldeo and Sandra Martin helped in the two hour session, after which the youngsters went home tired but happy.

As mothers watched, hoping no doubt that their child would be so tired as to rest until the holiday was over, Andy assessed the talents of SE1 youngsters. "They won't be after my place in the team now," he said, "but in a few years, who knows? What I hope is that all of these here today attend the training at Hatfields on Friday evenings, between 6 and 7pm. Then they can develop their skills. Then if they form into teams and

enter competitions, they can really progress. Proper coaching improves skills, and increased skills adds to enjoyment."

The training with Millwall player Andy was part of the half-term programme at Colombo Street. Action Sport worker, Yvonne, commented, "The idea for this came from the under 11s club, held between 4 and 5.30pm on Wednesdays. If other children would like to come to Colombo Street on that evening we would be delighted. We can introduce them to a number of

sports, including netball, basketball, badminton, tennis and table tennis.

"For the younger children there are party games. We welcome parents coming along, and get them involved in the activities. It pleased me to see Millwall responding so readily from a request from the local community. I think everyone benefits from this joint initiative."

The local newspaper!

2 DR. WATSON'S Diary Health Project Mothers

MOTHERS GROUP at Borough Community Centre, 56 Southwark Bridge Rd, SE1. Talks start 1.30pm, but centre open from 12.30.

November 9th: Your feet, by a diropodist.
16th Crafts
23rd: Toys for Christmas:
Joan Neve, Health visitor
30th: Crafts
December 7th: Childrens books for Christmas: Jean Early, Librarian (books for sale)

Come Dancing

SO YOU THINK YOU CAN'T DANCE???

You can take five weeks to change your mind..... At a short course Friday evenings from November 12th to December 17th (no session November 26th). 7.30 to 9.30pm at Kennington brnach of Southwark Adult Education Institute, Junction John Ruskin St and Bethwin Rd, SE5. Oval tube, bus Camberwell New Rd.

Cost £8 or £2 per session, reductions possible for low incomes. Wear loose clothing. If you want to know more contact Pete Keal, 320 Southwark Park Road, SE16, or phone him on 237 9901 between 9 and 11am.

KIDS' PARTY

KIDS CHRISTMAS PARTY

for 100 local kids at the Borough Community Centre, 4th December. For 4 to 11 year olds, with Olive Oil and Popeye making an appearance. There are places available, and it's free, so if your child would like to go, contact Linda Kerley on 928 6476 for more details.

CONCERTS

13th November at Morley College: Family concert: Saturday Songbook, plus making electronic music and dance. 10.30am to 12.30. 50p adults, 25p children, refreshments available during interval.

Morley College, 61 Westminster Bridge Road, SE1

23rd November, (Tuesday) 7.30pm at Southwark Cathedral: Morley Symphony Orchestra play Honneger, Patterson and Bruckner £1.50, £1 students and o.a.p.s

Local Artist

Dave Cooper, born in Rotherhithe, now living in SE1, as caretaker of Pickwick Centre, is one of four Southwark artists whose pictures are on display at the South London Art Gallery, Peckham Road, SE5.

As might be expected, a large number of pictures are local or London scenes.

Admission free, to 11th November 10 to 6, closed Mondays, 3 to 6 Sun.

HEALTH PROJECT DIARY OF EVENTS

Monday: Ante-natal group, 2 to 4pm at the Barley Mow Clinic, Frazier St (Tanswell Estate). Creche provided.

Tuesday: drop-in counselling 7 to 9pm at Barley Mow.

Wednesday: Pensioners Health Club, 10.30 to 12 noon. Tea and biscuits provided at Barley Mow. Dates; November 10th: Outing 17th: Home safety for the elderly 24th: Appliances and alterations to shoes by a diropodist.

December 1st: Holiday slides of the USA

8th: Discussion

Thursday: Yoga at the Barley Mow 10.30 to 12 noon

Tanswell Mothers and Toddlers

Drop-in

4 Santley House, Tanswell.

Open 9.30- 12.30,

1.30 - 4pm

Tuesday, Wednesday

and Thursday.

Childrens Health Club

5 to 12 year olds.

Saturday mornings at Waterloo

Action Centre, 14 Baylis Rd,

10.30 to 12.30

NELSON'S COLUMN



'No Regret' by W.H. Muckle

This is the story of Bill Muckle, who at the age of 81, wrote about his life and work in the coal mines where he worked for 52 years. It is a book which I felt held and gripped me with interest about Bill's struggle. He started work when he was 13, down the mines.

It is illustrated with photographs dating back to 19 with a photo of Bill and his pals underground in 1942. He also took part as he says the derailment of the Flying Scotsman in the General Strike in 1926. As he says, they were blacklegs, and the train should not have been running.

Well worth the £1.50. Published by Peoples Publications, New Enquiries through James Nelson this book.

CARPENTER REQUIRED

CALLING ALL CARPENTERS

Is there anyone who could make up a couple of screens, 5 foot by 3 foot, pinboard on one side, hardboard on the other, for the Childrens Health Club? We'll provide the wood and a small payment.

Please contact Paul at the Waterloo Action Centre, Thursday or Friday.

XMAS SALE!

BLACKFRIARS SETTLEMENT WORK CENTRE for the disabled are holding a SALE of the goods made by their disabled members on November 18th, 10.30 to 2.45. All articles are HANDMADE.

TOYS, CHRISTMAS CARDS, WOOLLEN RUGS, PLANT POT STANDS, JUMBLE and much more.

Buy now for Christmas, all proceeds go back into the Centre

NEW SURGERY on TANSWELL

ADDITIONAL ALLIANCE COUNCILLOR SURGERY: at 4 Santley House, Tanswell Estate, Frazier St first Tuesdays of the month. Also still every Thursday 6.30 to 7.30 pm or later at the North Lambeth Neighbourhood Council. Lambeth Walk, SE11

TENANT'S TALK

Southwark Council have put forward proposals to get greater tenant involvement in the decisions that their Housing committee makes. Here are the bones of the scheme:

Tenants representatives from each of the six housing districts in Southwark would actually sit on the council's Housing Committee, which would have a total of twenty or so members. They could vote, but obviously could be easily outvoted by the councillors who make up the rest of the committee.

This would give a lot of responsibility to a few tenants representatives: how would they be elected by or report back to other tenants? Some way needs to be worked out to make sure that they are accountable and representative of tenants, otherwise this would not actually improve relations between tenants and the council.

Secondly, the six housing districts would each have a district committee, with tenants representatives from Tenants Associations. These committees would have control of the housing budget for the district. In Bermondsey this amounts to £2.2million each year!

These district committees would decide on issues such as whether major repairs should be undertaken; policies on allocating council flats and houses; general maintenance matters.

in the Cold

The main problem with this is again making sure that the committees are in fact representative. Not all council estates have Tenants Associations, and those that don't always support them very well. So there is the risk of some tenants being left further out in the cold as the stronger TAs have their say, and nobody fights for them.

Thirdly, there would be neighbourhood committees. Exactly what these would do is not yet clear, and is going to be discussed more. They would probably, though, be responsible for a small team of council workers (plumbers, electricians etc) which would do less major repairs on a large estate, or a group of smaller estates or neighbourhood.

How these neighbourhood groups will be set up, and the area they will cover is yet to be decided. But it is vital that this is got right if they are to be effective. The questions which need to be asked are: who would control the speed and quality of the repairs the neighbourhood units do: tenants reps or the council?

How much money would the neighbourhoods be responsible for? How about specialised jobs that the local teams could not handle?

As these questions are still up in the air, your TA should discuss them, or you should find out more yourself from your local councillor, and discuss it with them. It will be no good the council setting up a structure which is meant to make things happen more locally instead of some remote part of the Town Hall, if the local people don't actually benefit from it!

'SE1' would also like to know more about how much consultation is taking place, and whether public meetings are taking place in SE1 to discuss the implications. Let us know your views on how council housing decisions can be made more relevant to people living in it in SE1.

TANSWELL

TANSWELL ACTION GROUP

Would Tanswell residents like to extend their action group to include social activities? It would provide more contact and allow time to talk about other things than housing problems.

Tanswell's first AGM in at least 3 years was held on 27th October. Ordinary meetings are held according to need, for example, to discuss plans for improvements of the courtyards with housing officials and local councillors. In mid December Tanswell hopes to meet with housing management to finalise these plans, which will include enlarging rubbish chutes, planting of trees and raised flower beds, and provision of a playarea and sitting out area.

Commuter parking has been a problem for years. It is difficult to know how many cars belong to residents alone, therefore the number of car parking spaces to be included in improvements has yet to be decided.

Tanswell's drains flood regularly in bad weather. Lambeth intends to survey all the drains which lead from ground floor flats into the courtyards - it is important to carry out repairs to drains before the courtyard are improved. Tanswell hopes to register with Kennington District Housing Committee, where residents' associations are represented. This committee will have a say in major programmes such as improvements and dampproofing.

If you could represent Tanswell on this committee, or if you have any further enquiries, leave a message either at No.4 Santley House for Tanswell Action Group, or with Waterloo Action Centre in Baylis Road.

PETITION

Myself (Lou Shepherd) and my neighbours have been going around door to door getting people to sign a petition about how dangerous it is to walk through Windmill Walk (off the Cut) to the shops.

It is even worse now, since they re-made the pavements. It lasted one day: all it needed was one lorry to mount the pavement and that's what happened. Sure enough it has pushed the kerb stones and pavement (asphalt) out of place, making it hard to walk on. It is just as bad in Greet Street (the next road along).

There have been more minor accidents this year. One person got hit in the face by a passing lorry: its wing mirror caught her. I have been soaked from head to foot when a car dashed down Windmill Walk and hit a puddle, simply

because there is no room to get out of the way.

Elderly people have fallen over on the pavement, it is so bad.

Over a hundred people, in the small area near the danger spot have signed the petition. We have sent it to the principal planning officer at Lambeth Council to arrange a meeting. We now await their reply. I do hope all our neighbours will come to the meeting when it is arranged, and say what they think and what they want done.

SE1 ADDS: A year or so ago there were proposals to close Windmill Walk, which were rejected by council officers. Our photograph shows how little space there is on the pavement next to 'The Windmill' pub, with a Lambeth dustcart blocking the whole width of the road.



CONFUSION

Tenants in Cooper Close, Waterloo Road, are in a very odd position. In an area which is really part of Waterloo, most of which is in Lambeth, they are in Southwark, but the only council block in that borough which still belongs to the GLC. So they rely on the GLC's depot in Lewisham for repairs!

On top of this, there is a two tier rent system, which means that newer tenants (the estate has only been occupied a few years anyway) pay lower rents for identical flats.

The confusion has come about because the previous, Tory, GLC, had built then intending that they should be sold to tenants as quickly as possible. To encourage this, they charged high rents, making it attractive for the tenants to buy the flats.

The new Labour GLC which came in May last year, doesn't approve of council house sales, so has stopped charging these extra high

rents, but only to new tenants as they come in, leaving the old tenants paying more.

Not surprisingly, people aren't happy with this system. A Tenants Group has now been set up for Coopers Close.

They are trying to set up a meeting with local GLC councillor George Nicholson to put their points of view. They have already had meetings with GLC officials, and it seems that they have no long term plans for the estate, although they probably don't want to keep it, and will pass it over to Southwark Council at some stage. (Other GLC estates in the borough were handed over to Southwark Council some years ago.)

There is also talk of a residential caretaker some time.

We hope that the GLC and the tenants can get things sorted out!

SPORTS OR HOUSES

Paris
Gardens

Last year, Southwark Council made a deal with the owners of the Melody Maker/IPC Social Club site between Paris Gardens and Hatfields in which the site would be handed over to the council. At that time, local people argued at a public meeting that it should be put to community use and that its future should be decided by them.

The deal restricted any possible housing to the Meymott Street and of the site. The rest was to be used to link up Hatfields open space with Christchurch Gardens, and to provide a link road between Hatfields and Paris Gardens. A public meeting has been called for local residents to decide on the future of this site. The GLC has money to spend on community schemes in this area so there is a good chance that a scheme could go ahead if it gets strong local support.

The meeting on Thursday 18th November at Colombo St. Sports & Community Centre, has been organised by the Association of Waterloo Groups, the Colombo St Centre, North Southwark Community Development Group and Waterloo Community Development Group.

The groups have drawn up some options for everybody to discuss but anyone else is free to suggest other ideas, and these will also be considered at the meeting.

Four options have been prepared: two using the land as a sports area and landscaped open space, and two for housing, small sports area and landscaping. Large scale drawings of these will be on display at the Colombo St. Centre, SE1 and Waterloo Action Centre, 14 Baylis Road, SE1 from November 11th. If you can't attend the public meeting on the 18th, you can leave comments and suggestions at the Colombo St. Centre.

A floodlit sports area, which could be used for hockey, basketball, netball, volleyball and tennis (two courts), and a landscaped open space.

Plan A.

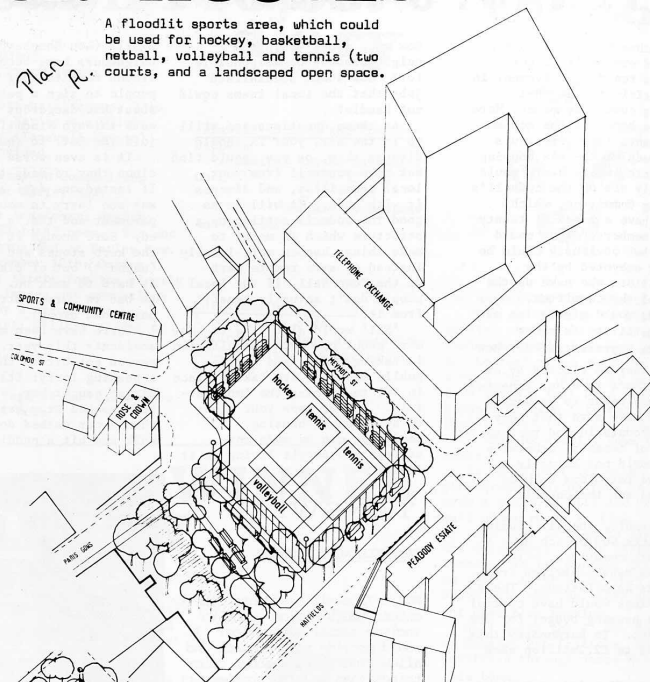

A smaller floodlit sports area than in Plan A which could be used for hockey, basketball, netball, volleyball and tennis (one court) and a larger landscaped open space.

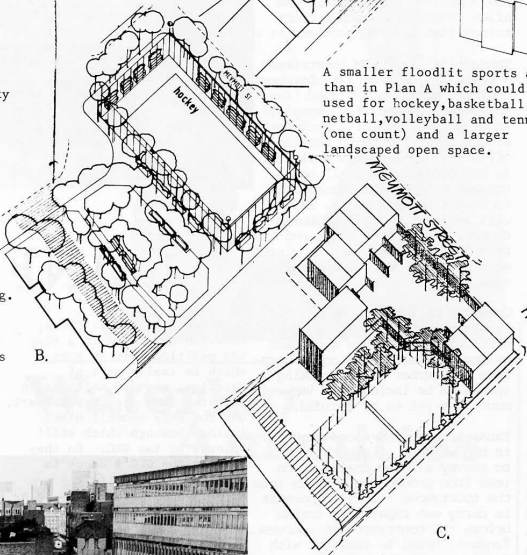

C.

Seven 3-storey family houses (six people in each) with gardens facing north/south and six 3-storey flats (3 people in each) with shared garden. Also included is a small floodlit sports area (tennis court size) and landscaping.

Seven 2-storey family houses (six people in each) plus 6 flats in a 3-storey block all facing East/West. The houses have their own gardens and a shared garden with the flats. Also included is a small floodlit sports area (tennis court size) and landscaping.



New Community Centre

The part of Bermondsey on the east of Tower Bridge, overlapping SE1 and SE16, is in many ways an island. It is isolated by large roads and railways, it is badly served by public transport and has little in the way of shops, open space and other facilities.

These problems are no strangers to most people in the SE1 area. Other parts have their groups and community centres which attempt to do something about it. Now people on the Arnold and Neckinger Estates, Devon Mansions, St Saviours and Dickens estates, the Lupin Point tower block and others have got together to establish a community centre.

The first public meeting at the height of the holiday season in August got 46 people along. A steering group of 17 people had already been formed and was rapidly bringing together proposals to convert the building. The hope of 'Community Areas Policy' money (see previous issues of SE1) had made a vague idea a definite possibility.

The premises on the corner of Druid and Abbey Streets is an old printing works, Nathaniel Lloyds. Wally Menteth, a local resident trained in architecture, has been turning ideas from the steering group and the public meeting into conversion plans for it.

On the other side of the spine are changing rooms and showers; a bar/club, with games and facilities for use for music, cabaret etc. On the first floor above this are smaller function rooms, which could also be used for various projects (youth club, literacy project) and a community workshop with equipment for carpentry, metalwork etc.

attached to the rest of the building, but can also be used separately, a creche and parents centre, including support projects for single parents.

Impossible to convey enthusiasm

It is impossible to convey in such a small space the enthusiasm and determination that Bette and Wally have, and showed in a 24 hour chat with our reporter. If the rest of the steering group have half as much as these two, then no doubt they will succeed in getting something going.

177 ABBEY St. Site, a future landscape option.

0 5 10 25m

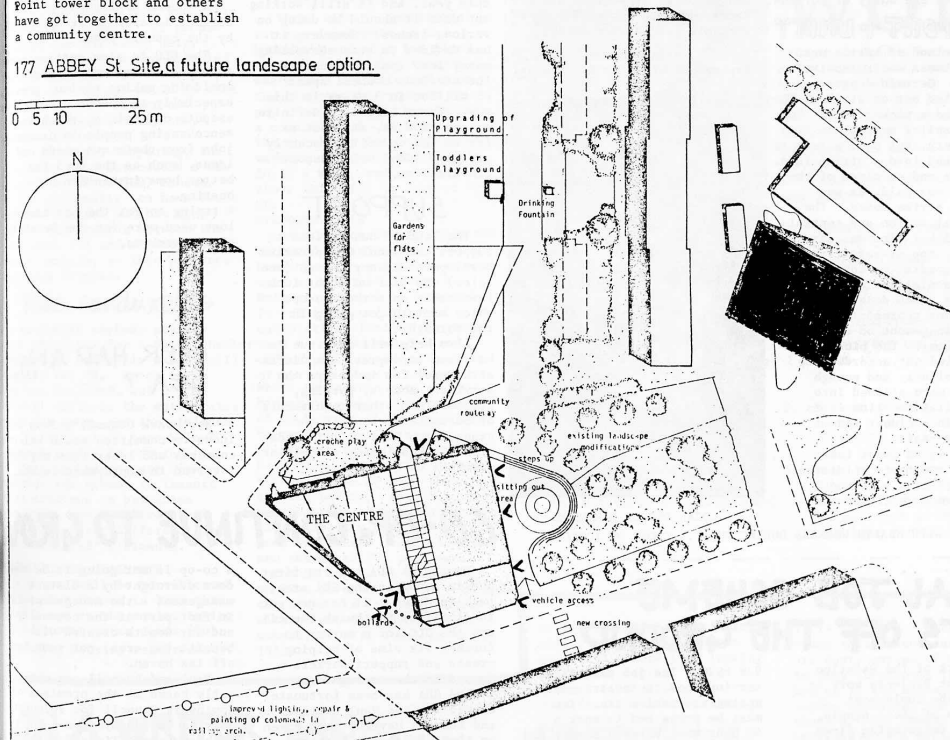
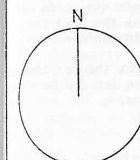

People make Communities

Sports, Drama, Cinema

The idea has long been in Bette Crickmar's mind, born in St. Olaves Hospital, taught at Dockhead Catholic School and always living in Bermondsey. As she says 'People make communities', and within a quarter of a mile of the proposed building there is a rather a lot of them, mainly on the estates listed above. None have any real community facilities, but it is a community nevertheless.

The plans include: a 'central spine' with a social area and cafe, a walkway through from one side of the building to the other, and the administrative area. The social area is particularly aimed at the elderly.

a multi-purpose hall on one side to the spine, for sports, drama, cinema, meetings etc.

Together, these proposed facilities would give vast potential and room for various ideas. It has been designed to be as flexible as possible. One important aspect: would be the creche and other facilities which would allow mothers with young children to leave them in safety while they take part in a sport or other activity elsewhere in the building.

Another way in which the centre could add to the area is by bringing together a number of small and not very useful pieces of open space around it. Wally is very keen that these be joined together, with the centre as manager of their use.

They are waiting to hear the result of their application to the GLC for money to buy the building and convert it. The have also put in for funding and Urban Aid from Southwark for workers to develop the use of the building. But there are quite a few other projects going after the same money, both from GLC and Southwark, quite a few also in SE1. (Quite a few have been featured in some way in this paper.)

But Bette says she will refuse to take no for an answer. If the councils want an easy life, they better find some way of supporting the community centre!

THE STRUGGLE FOR A VIABLE HEALTH SERVICE

As the dispute at St. Thomas Hospital drags into its fifth month, the workers are more determined than ever to fight on for their 12 per cent claim. All attempts to split this unity, whether at a local or national level have failed. When the government offered the Royal College of Nursing, the least militant union, the biggest pay increase, the effect at St. Thomas was not to divide and rule, it was to increase our solidarity and unity of purpose.

SUPPORT + UNITY

The method of battle used at St. Thomas was selective strikes. Certain departments were called out on strike. They maintained a picket line. The other hospital members continued to work, but paid a levy of £2 per head into a strike fund. The wages and earnings of the strikers was paid, as was official strike money. The industrial action and control of the picket line was carried out by a shop stewards and Branch secretaries committee.

Representatives of this committee which determined policy, met representatives of the management on day to day problems. The picketing was carried out according to TUC guidelines, and enough supplies were allowed into the hospital to allow it to work on an accident and emergency basis.

There is no doubt that patients and their relatives & loved ones have suffered. Wards have been closed and

waiting lists have been increased. Resources have been reduced. But the main responsibility is the result of Mrs Thatchers governments policy, based as it is on taking resources away from the public sector, and switching them to the private. It is the result of reducing the money supply and attempting to privatise sections of the National Health Service.

Behind the struggle at St. Thomas, bitter and hard as it has been, waged by the rank and file members of NUPE, COHSE, T&G ASTMS, is a cry for social justice and moral principle, supported by many people outside the health service, which the Thatchers and Fowlers of the world think that they can crush with threats of the dole queue and hospital closures. St. Thomas Hospital after 5 months struggle proves them wrong.

Arthur Downes, NUPE branch secretary at St. Thomas.



LOCAL PEOPLE MARCHING WITH HEALTH WORKERS DURING THE T.U.C DAY OF ACTION.

LOCAL JOB SCHEME GETS OFF THE GROUND

As part of the Waterloo Employment Projects work to improve the employment prospects of local people, they are encouraging firms who are based locally to employ locally. So here are details of the first positive response:

Anyone aged 18-30 who would be interested in working for a large entertainments complex on the South Bank, in their catering department, should ring Steph Blackwell on

928 8024. The job will involve serving food to theatre goers, acting as cashier etc. You must be prepared to work a 40 hour week between Monday and Saturday, and to work on shift between 9am and 9pm.

Free meals and a uniform are provided and the pay is at union rates. All employees must be prepared to join the union. On-job training will be given, and there are opportunities for advancement. The vacancies are open to both males and females.



BERMONDSEY C.N.D. DISCO

13th Nov 82 8pm - MIDNITE

tickets £1.50 Waived, £1 unwaged. all welcome! Nearest tube Surrey Docks.

A SPARK PERHAPS!

Unemployment has increased rapidly throughout the borough of Southwark in general and in North Southwark in particular. A press release from Judy Cliffe, chair of the borough's Jobs and Industry committee compares the borough with 'traditional' employment black spots like Bolton, Wigan and Swansea, which all have fewer people unemployed!

With Southwark's unemployment figure standing at just under 20,000, a 160% increase since 1979, there is a lot of talk about creating new jobs. The Jobs and Industry committee was only created in August of this year, and is still working out what it should be doing on various issues. However, it has decided to stop shovelling money into small businesses - the previous council spent £3 million in 3 years in this way. There is little definite to show for it, at least as far as the council's recently produced 'Monitoring Report' can discover.

SUPPORT

The council has decided to support the Local Co-operative Development Agency though (see below) and will no doubt look favourably on worker co-ops which want to get going in the borough.

Also help will continue to be given to improve the 'infrastructure' for industry: the services, access, parking, premises and other requirements of businesses, new, old and expanding. This will include grants for bringing old vacant premises back into use.

Employment training is currently under review, as is what can usefully be done with the 'Southwark Aid Company' originally set up by the old council. It could be used to create jobs in various ways - maybe even by 'municipal enterprise': making and installing equipment which the council has to buy elsewhere. For example, this could be the manufacture of entryphones for council flats, or park benches.

WOMEN

A womens employment project officer is also to be appointed by the council soon.

The GLC is also getting more involved in employment issues, including making various grants, especially to co-ops. Two other aspects of their approach are: *encouraging people to create jobs from their own needs and ideas, such as the need for better home insulation and heating.

* trying to get the new technology used more for the benefit of the workers.

EVER HAD AN IDEA?

Southwark Council's Jobs and Industry committee would welcome comments and ideas from anybody involved in employment issues.

CO-OP. CONTINUE TO GROW

Southwark CDA had its first public event in the SE1 area, back in March. It has now got funding from Southwark Council and the GLC for a worker to further its aims of helping create and support workers co-ops in the borough.

The CDA has been fortunate enough to find Paul Williams and Russell Hay who have taken on the post as a job-share. Having both been involved in printing co-ops, they have had first hand knowledge of the problems and advantages that co-ops can give.

As worker co-ops are completely controlled by the work force of the business, without any outside shareholders, there can be difficulties raising money to get the business going. Sometimes it can even be difficult to get credit from suppliers. But on the other hand, co-ops mean that the workers have control over what they do and how it's done: they are more likely to be concerned with the welfare of the workers than how to make a profit regardless of the means. They have the extra advantage to the community that

a co-op is not going to be shut down overnight by a distant management - the management is in fact part of the community and any wealth created will benefit the area, not some far off tax haven.

Paul and Russell are currently based at the premises of Southwark Council for Voluntary Service at 135 Rye Lane, Peckham (above Times Furnishing). But a priority is to find more permanent premises in the northern part of the borough - where the needs, but also the possibilities, are greatest.

The CDA is keen to help any group which wants to set up a workers co-op in the borough, and can point you in the right direction for help with finance, premises, setting up the organisation etc. As the Council are still working out its precise policy, there is no set procedure for them giving help, but they have already given one grant to a co-op currently based near the Elephant and Castle. So if you have an idea, or would like to find out more, contact Paul or Russell on 732 9777, or drop in.

WHO BENEFITS?

HOUSING BENEFIT

For many years, subsidies towards the housing costs of those on low incomes have come from two separately administered sources: Supplementary benefit payments (DHSS) and rebates/allowances (local authorities and DOE). Provided a claimants income did not exceed her/his supplementary benefit requirements (SB), housing costs were paid in full by the DHSS. Those who had a higher income, but who still needed help to pay the rent got a contribution towards their housing costs. Those not eligible for SB at all on the other hand, might have been eligible for rent and rates rebates/allowances. If people applied for the wrong help, they stood to lose, and this led to a 'better off' problem: people on the same income could in fact end up worse or better off depending on which way they claimed assistance.

To stop this happening, the government has introduced a new Housing Benefits (HB) Scheme. It was originally to have been called 'Unified HB' but many of the differences between the two forms (SB and rebate/allowances) remain, so this pretence has been dropped.

Ham sandwiches

Basically anybody paying rent and rates for a home, whether council or privately owned, will qualify for HB. Water rates are not included, but if the council collects the water rates with the rent, and the claimant is 'certificated' (see below) then they will be covered.

Heating charges are also outside the scheme so tenants must continue to pay these direct to the landlord, but see below for a difference for 'certificated' claimants.

CERTIFICATED CLAIMANTS

A person will be certificated if his/her income is less than that given on the scale, taking into account extra needs (but excluding housing requirement).

ON A WRITER VANE

Should writers' groups carry a government health warning?

I always thought that censorship and the restriction of literature was the art of bureaucratic Muscovites and the latest Latin American dictators. But it was wrong! Because these crimes have raised their ugly heads on a relatively small part of the South London writing scene.

I've written in this paper before that I'm a member of the Bookplace Writers group in Peckham High St, that now meets every Monday at 7.30pm (quick plug!) The group had been planning a publication of poetry and a few short stories since September 1981.

The DHSS (Social Security) identifies the claimant and sends a certificate to the local council telling it to meet 100% of the claimants eligible housing costs. Council tenants will have no further rent or rates (and possibly water rates) to pay, but will have to pay heating charges directly to the landlord. Housing association and private tenants will be paid their rent and rates by the council. There will, therefore, be no change in the amount of benefit received, just a change in the method of payment.

Pay attention!!

There will be deductions for non-dependants in the household and also for fixed amounts for heating charges where in a certificated case the claimant is required to pay fixed heating charges as a condition of the tenancy. The total sum for heating/hot water/cooking and lighting is £6.25 a week, and so anything above this will be covered by HB.

STANDARD CASES

Standard cases are those who received contributions towards housing costs and those who were on rebates/allowances. Both groups will be assessed for HB in accordance with calculations similar to those used to assess rebates and allowances. However, because of certain 'taper' changes (where the person gets a higher or smaller proportion of HB because their income is below or above the needs allowance) an HB supplement has to be paid so that no-one receives less HB than they were getting before. Also for those were on rebates/allowances, there will be temporary additions to keep any losses caused by the new scheme to 75p per week.

The HB scheme is introduced on 22nd November for certificated cases who are council tenants with no non-dependants. For others, it will start in April 1983.

Since 27th September the Kids Health Club has had a new worker - PAUL BONEIL. The Health Club is for 5-12 year olds and is held on SATURDAYS from 10.30 - 12.30 at WATERLOO ACTION CENTRE (no longer at the Adventure Playground). Anyone interested in the club and that includes parents, and fathers in particular, who might like to help out, is invited to pop in on Saturdays, or to phone Paul Thursdays, Fridays and Saturdays on 261-1404 during the day, or at home on 738-8490.

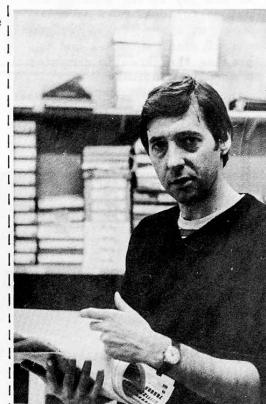

-KER

NEW

Paul would like Club members to learn about health issues in an enjoyable way, e.g. through games, painting and films. He would also like to establish closer contact with Kennington Kids Health Club and the Young Vic Youth Theatre, to form a Club for the over 12's around the theme of drama to discuss roles and relationships. Paul wants to make an allotment available to Club members, so anyone who knows of vacant allotments would be doing the Club a favour by letting Paul know (see phone numbers above).

WOR-

So what is Paul's background? He is married with two children Rachel aged almost 4, and Fynn, 18 months. He and his wife share both breadwinning and child raising. Paul has 5 years experience in London adventure playgrounds, including Notting Hill Gate and Horniman Pleasance near Kings Cross.

More recently Paul was writing plays for a theatre company formed with friends, called Platform 6, which is a theatre of education, acting in schools around the theme of behaviour and equality.

He has written the following 2 plays:-

1. Selling Sweat - written specifically for 13-16 year olds, this is set over the weekend when the Welsh boxer, Johnny Owen, died in the ring. The play challenges the attitudes of professional boxing.
2. Megaman and the Threat of Zenula - written for 9-11 year olds, this play uses comic strip superheroes to look at the mythology of Superman - it is only very recently that female super heroes, such as Wonderwoman, have been introduced.

at the receiving end of many moans. but he defended himself with discretion, leaving us feeling better, and a strong sense of our own justification at complaining.

Words became confetti, and bad feeling set in. Two members complained about another's work, saying that it was both racist and sexist. Misfortune coming from battalions rather than single spies, the accusations were being made against a writer who was now in Holland.

At first a proclamation was made about the offensive nature of writing and a disclaimer was going to be made about this. There were discussions-cum-demonstrations of powerful vocal chords, and weak ear drums. The two complainers were threatening to take out their work, but they didn't need to, because the management committee stopped distribution.

It is now over 3 months since these events and there are dusty copies of work lying in many stockrooms from Peckham up to the Borough, not saying anything. The plain-tives are not coming to new sessions of the writers' group, which started after the summer recess, and excluding them the group has been at least halved.

There were lots of arguments about the work in question. The writer said he was being ironically sexist and racist. But along with that all the other work is lost. I'm guilty of all mistakes of human behaviour mentioned in this article except censorship. Because I think it's morally wrong to restrict others' freedom on grounds of the 'moral' views of the few.

Sean Mitchell.

8 OPEN DAY

In the heart of Waterloo, just off Stamford Street, two forbidding red brick blocks shelter between them a surprising haven of grass and flowers; a play space for children and a place of safety for people of any age. This is the Edward Henry House Co-operative: a positive result of the years of campaigning for more and better housing in Waterloo.

The first residents moved in almost a year to the day when Edward Henry had its formal 'opening' on October 23rd.

The weather was kind and the day started off bright and sunny as though the gods had chosen to bless their day and

venture after so much rain during the previous weeks. The residents of Edward Henry had obviously spent a lot of time and care in planning the day which was to record the hard endeavours of all the people who had put time, effort and love to get the project off the ground and keep it floating.

The day started with laughter and joy as the bunting was put up followed by a of fun mixed with the formal ceremonies of planting trees and opening the recently completed community centre.

(The community centre is named after one of the co-ops members who died before moving in - Jack Rannard)

The fun included assorted events for children like the treasure hunt, fancy dress competition, sports events and talent competition. Also a few events for adults: five-a-side football between the Cornwall Road and Coin St sides (very serious), a visit to the local (fairly serious), and a men-versus-women netball match (although it was difficult at times to tell which side was which, as they had switched clothes, and it resembled a rugby scrum more than the game it was supposed to be).

The day ended with a family 'disco' in the community centre which seemed to be enjoyed by all. It was a day to remember, a day to celebrate the work of laying good foundations, a day to thank all those who laid them, and to express confidence in the future of the co-operative and its part in the community.

join us

The SE1 group warmly invite you to come and take an active part in your local paper.

We need people to help out with all aspects of writing, producing and distributing it (you can spend as much or as little time as you please). We also desperately need contacts - people who are involved in some local group or just individuals who are prepared to give us a ring when they hear about something interesting happening. You needn't even write the story yourself although we would be happy to give you help and advice if you do want to.

So, if you would like to offer us a bit of your time and energy (there are no skills involved which we can't teach you) then why not come to one of our meetings? They are always advertised in the paper, or if you prefer, give us a ring and find out a bit more.

The next issue will be our double Christmas issue, out on December 3rd. Meetings to get it together are 10th and 24th November at 7pm in the SE1 office. All contributions must reach us by the 24th, for pasted up 27/28th.

You can contact us by ringing Rob on 735 5168, John on 928 4748, or Nick on 261 9119, or leave a message Waterloo Action Centre on 261 1404.



FUN RUN

THE WATERLOO EMPLOYMENT PROJECT AND ACTION SPORT PROUDLY PRESENT:

THE WATERLOO CRAZY FUN RUN

On Sunday November 21st at 1.30pm a strange sight will be seen on the forecourt of the National Theatre (the big grey building to the right of Waterloo Bridge). Various British athletes, politicians and members of the local community will gather together to warm up before starting their run to the Colombo Street Sports and Community Centre. When they arrive at Colombo St, they will be able to see Action Sport 'in action'

putting on martial arts, gymnastics, dance and various other displays - anyone who wants to try some of the sports can.

To keep everyone jumping up and down and warm the Capital Radio Cruiser will be at the start providing music, competitions and fun & games. They will be starting the run for us at 3pm.

Run, did I say? Well actually not that much running will take place. Some people will be on rollerskates, others on bicycles, a variety of rather large adults in prams, and who knows what else might happen. One thing is for sure, it will be completely crazy! (Which might give problems to the athletes, some of whom recently competed in the Commonwealth Games.)

Anyone can take part in the run, and the best one in fancy dress will get a special prize. If you can walk, trot, crawl, roller skate, ride a bike, hop or anything else then join in. Hopefully we'll have a band to lead us on our way.

WHY BE MAD?

So why should a group of people take it in their heads to give up a quiet Sunday afternoon to be crazy in Waterloo? Well, the answer is simple. The Waterloo Employment Project was set up by and for the local community to improve the employment prospects of local people. Action Sport are a group of sportspeople, funded by the GLC and the Sports Council to get ordinary people locally more involved in sport. The one thing they have in common is that they are both based at the Colombo St. Sports and Community Centre, off Blackfriars Road, SE1. We want you to get to know us and use our services, so we're providing some entertainment to introduce ourselves to you.

If you would like to come to watch or join in, or both, then come along on Sunday 21st November, 1.30pm to the front of the National Theatre. The start is under cover, so don't worry if it's raining. The whole

SHORTS.

COIN STREET LATEST

We understand that the Inspectors report on the long running Coin St. inquiry has now gone to the Department of the Environment where Mr Heseltine will make a final decision on what is to happen. It went to the DoE the third week in October, but a decision could be taken anytime from now.

ROYAL VIC - SUPERPUB

Waterloo residents will have noticed that the pub next to the Old Vic on Waterloo Road, which lost a lot of custom when the actors left the theatre, has closed for alterations.

The plans are to turn it into a 'Taffs Superpub'. They have applied for a music and dancing licence, which would allow them to go on to 2 in the morning if granted.

afternoon's programme of events is free, and we'd love to see you there, so brighten up that dull winters day by joining in our CRAZY afternoon!